

Edge Large Format Display System

From oversized wayfinding maps and building directories to large display needs for educational, transportation and retail facilities, Arris Edge is the perfect solution.

Arris Edge is not a "snap-frame" system like other large, low-profile displays on the market. Edge is a well engineered, tamper-resistant display system for when durability, security, and image matter.



Scan QR Code
to Learn More...



"I wanted to Thank You and say how great it is to work with the staff at Arris signs. They do everything to make sure that you get exactly what you have ordered in a timely manner with a great and very versatile product.

Nick Yakouba
Contemporary Visions
Camas, WA

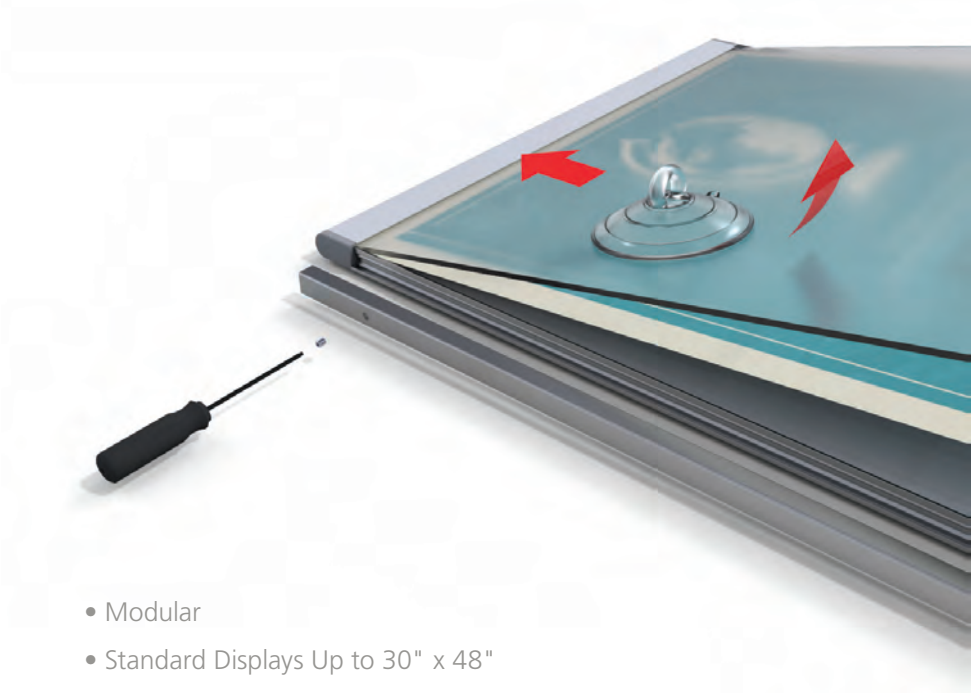

- Modular
- Standard Displays Up to 30" x 48"
- Custom Sizes Available
- Durable, Satin Anodized Aluminum Frame Extrusions
- 1/8" Thick, Non-Glare Acrylic Lens to Protect Displays
- Locking Edge Extrusion for Security & Graphics Compression
- Aesthetically Compatible with the Entire Arris Sign System



WMLA-E2222
 Frame: 24.25" h x 22.5" w
 Insert: 22" h x 22" w
 Visible: 21.87" h x 21.68" w



WMLA-E2822
 Frame: 30.25" h x 22.5" w
 Insert: 28" h x 22" w
 Visible: 27.87" h x 21.68" w



WMLA-E3022
 Frame: 32.25" h x 22.5" w
 Insert: 30" h x 22" w
 Visible: 29.87" h x 21.68" w



WMLA-E3622
 Frame: 38.25" h x 22.5" w
 Insert: 36" h x 22" w
 Visible: 35.87" h x 21.68" w



WMLA-E4222
 Frame: 44.25" h x 22.5" w
 Insert: 42" h x 22" w
 Visible: 41.87" h x 21.68" w



WMLA-E4822
 Frame: 50.25" h x 22.5" w
 Insert: 48" h x 22" w
 Visible: 47.87" h x 21.68" w



WMLA-E2224
 Frame: 24.25" h x 24.5" w
 Insert: 22" h x 24" w
 Visible: 21.87" h x 23.68" w



WMLA-E2824
 Frame: 30.25" h x 24.5" w
 Insert: 28" h x 24" w
 Visible: 27.87" h x 23.68" w



WMLA-E3024
 Frame: 32.25" h x 24.5" w
 Insert: 30" h x 24" w
 Visible: 29.87" h x 23.68" w



WMLA-E3624
 Frame: 38.25" h x 24.5" w
 Insert: 36" h x 24" w
 Visible: 35.87" h x 23.68" w



WMLA-E4224
 Frame: 44.25" h x 24.5" w
 Insert: 42" h x 24" w
 Visible: 41.87" h x 23.68" w



WMLA-E4824
 Frame: 50.25" h x 24.5" w
 Insert: 48" h x 24" w
 Visible: 47.87" h x 23.68" w



WMLA-E4127
 Frame: 43.25" h x 27.5" w
 Insert: 41" h x 27" w
 Visible: 40.87" h x 26.68" w



WMLA-E2230
 Frame: 24.25" h x 30.5" w
 Insert: 22" h x 30" w
 Visible: 21.87" h x 29.68" w



WMLA-E2436
 Frame: 26.25" h x 36.5" w
 Insert: 24" h x 36" w
 Visible: 23.87" h x 35.68" w



WMLA-E3636
 Frame: 38.25" h x 36.5" w
 Insert: 36" h x 36" w
 Visible: 35.87" h x 35.68" w



WMLA-E2741
 Frame: 29.25" h x 41.5" w
 Insert: 27" h x 41" w
 Visible: 26.87" h x 40.68" w



WMLA-E2242
 Frame: 24.25" h x 42.5" w
 Insert: 22" h x 42" w
 Visible: 21.87" h x 41.68" w



WMLA-E2442
 Frame: 26.25" h x 42.5" w
 Insert: 24" h x 42" w
 Visible: 23.87" h x 41.68" w



WMLA-E3042
 Frame: 32.25" h x 42.5" w
 Insert: 30" h x 42" w
 Visible: 29.87" h x 41.68" w

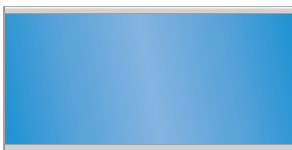

WMLA-E2248
 Frame: 24.25" h x 48.5" w
 Insert: 22" h x 48" w
 Visible: 21.87" h x 47.68" w

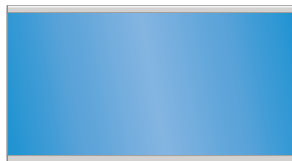

WMLA-E2448
 Frame: 26.25" h x 48.5" w
 Insert: 24" h x 48" w
 Visible: 23.87" h x 47.68" w

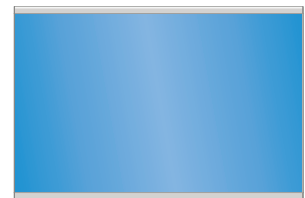

WMLA-E3048
 Frame: 32.25" h x 48.5" w
 Insert: 30" h x 48" w
 Visible: 29.87" h x 47.68" w