

## The Two Assemblies

**SA Standard Assembly**  
For signs up to 11" wide

**LA Large Assembly**  
For signs greater than 11" wide

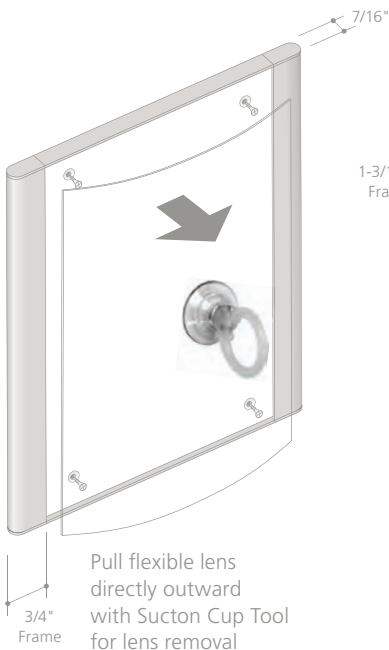

Pull flexible lens directly outward with Suction Cup Tool for lens removal

Add 1-5/16" to insert width for outside frame width.

Add 1/8" to insert height for outside frame height.

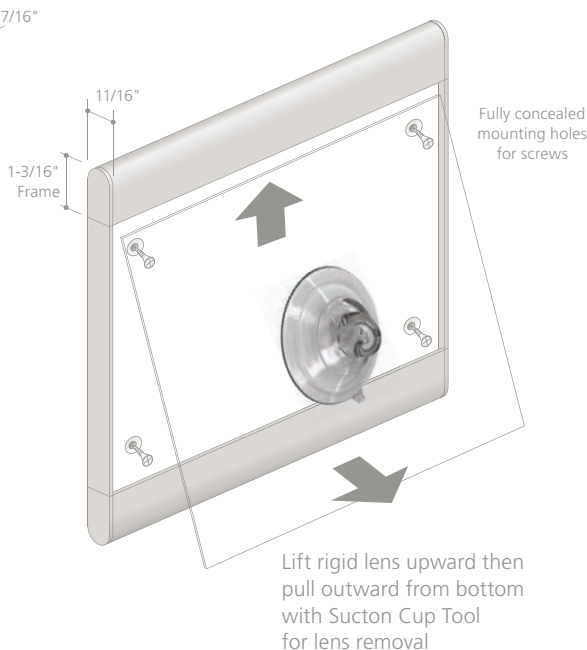

Lift rigid lens upward then pull outward from bottom with Suction Cup Tool for lens removal

Add 3/16" to insert width for outside frame width.

Add 2-1/4" to insert height for outside frame height.

## SYSTEM OVERVIEW

**Simply Modular. Surprisingly Complete.**

Life is complicated. Your sign system shouldn't be. Arris offers well-designed, **proven solutions** for all type of interior signs, but does so without being overwhelming.

The Arris system is simple to understand, with low-profile, extruded aluminum frames and clearly defined sizes and options. At the same time, Arris packs a powerful punch, offering a virtually limitless range of custom sizes and flexibility to suit your project's specific needs. And, frames are designed to accommodate a wide range of display materials and graphics solutions, so design options are limited only by imagination.

## DRESS IT UP WITH ACCENTS!



.040" Aluminum Connector with Pre-Applied Adhesive Attaches Securely to the Back Side of a Standard Arris Frame.

**Compatible Arris Frame Widths:**  
(4", 6", 8.5" & 11")



1/8" Thick Acrylic or Wood Laminate Accent Shape Attaches to the Aluminum Connector, Flush with the Top (and / or Bottom) of the Arris Frame.



The Finished Arris Accents Assembly Represents the Easiest and Most Cost-Effective Way to Incorporate Decorative Shapes into Your Signage Design

### Colors:

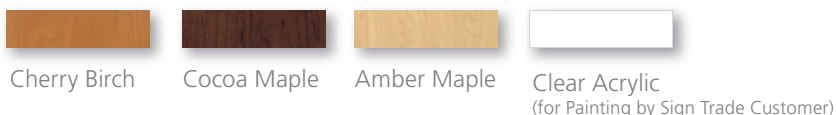

### Shapes:



## ACCENTS

Shape up your next project with **Arris Accents**, the easiest and most cost-effective way to incorporate decorative backers into your signage design. Offered in a range of shapes and sizes with virtually limitless possibilities, **Accents** provide a unique touch for your sign system to coordinate with a facility's interior or corporate brand.

**Note:** Accents is not compatible with M-Series.

